

THIS DOCUMENT CONTAINS PROPRIETARY INFORMATION WHICH IS THE PROPERTY OF OSC AUDIO PRODUCTS, THAT MAY NOT BE REPRODUCED, REPRODUCED OR USED WITHOUT EXPRESS WRITTEN PERMISSION FROM OSC AUDIO PRODUCTS.

REVISONS		DESCRIPTION	BY	EFF DATE	ISSUED
REV	ECD				
A	-	RELEASE	JD	18-JUL-11	-

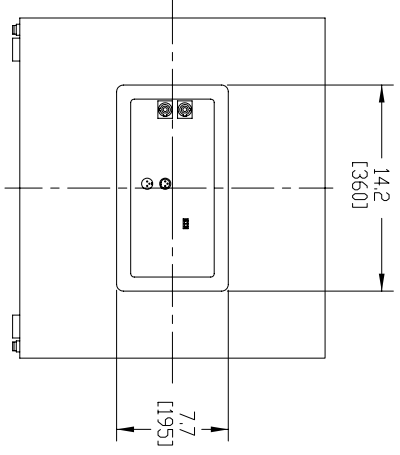
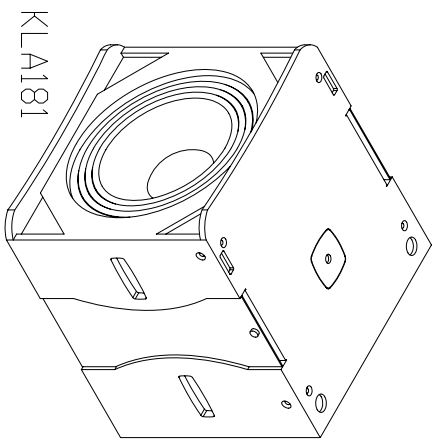
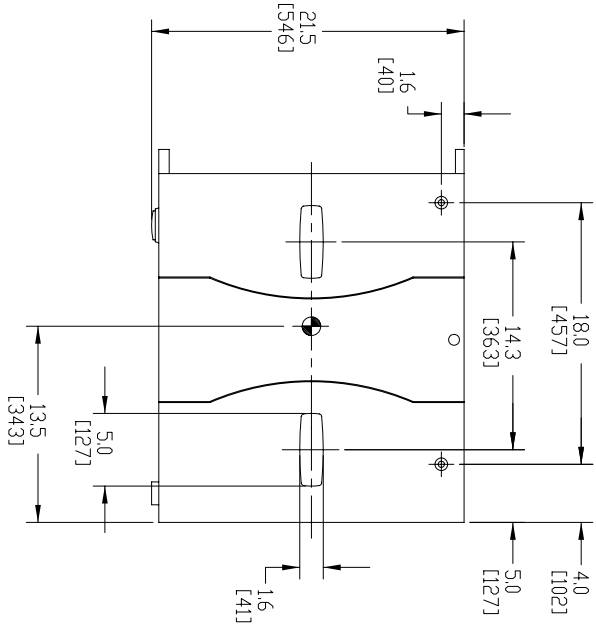
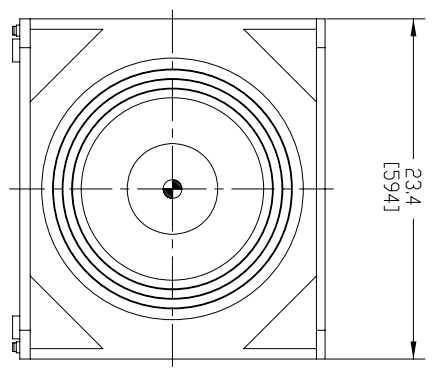
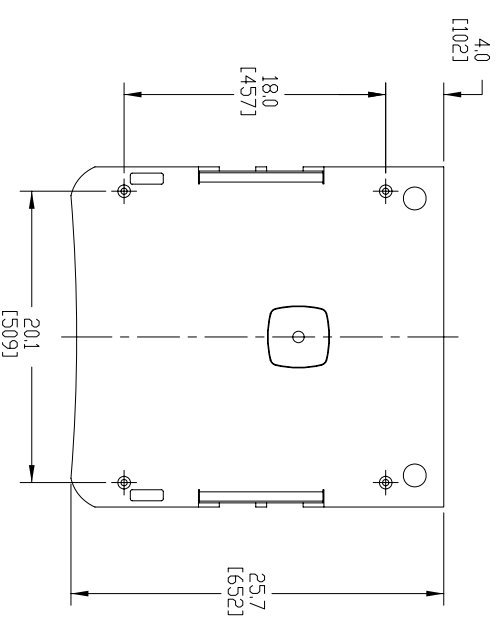

5. PARTS ARE SYMMETRICAL ABOUT CENTER LINES UNLESS OTHERWISE NOTED.
 4. SYMBOL \oplus INDICATES CENTER OF BALANCE.
 3. SYMBOL \odot INDICATES SUSPENSION POINT,
 - 8 TOTAL: M10-1.5 THD.
 2. TOLERANCES (INCHES): X \pm .13, ANGLES: \pm 1°
 1. NET WEIGHT APPROX. 104 LBS (47.3 KG)
- NOTE: UNLESS OTHERWISE SPECIFIED

UNLESS OTHERWISE SPECIFIED DIMENSIONS IN INCHES (MM) TOLERANCES ARE: DECIMALS \pm .005 (0.127) ANGLES \pm 1/2° HOLE DIA. \pm .005 (0.127) HOLE DIA. \pm .005 (0.127) HOLE DIA. \pm .005 (0.127) HOLE DIA. \pm .005 (0.127) HOLE DIA. \pm .005 (0.127) HOLE DIA. \pm .005 (0.127)		APPROVALS	DATE	 OSC AUDIO PRODUCTS, LLC 1675 MACARTHUR BOULEVARD COSTA MESA, CA 92626
DESIGNED BY P. SANCHEZ	CHECKED BY P. SANCHEZ	DATE 29-JUN-11	DATE 13-JUL-11	
MATERIAL		FINISH	DRAWING NO. FG-001237-2D MODEL INFD. FG-001237-3D/A/D SCALE: 1:1	