

# K Series

## Hookup Drawings

**QSC**

If you would like a full copy of the K Series User manual, visit the QSC Audio Products website at [www.qscaudio.com](http://www.qscaudio.com), or contact Customer Service +1 714 957-7150 or toll free (USA only) 1-800-772-2834 to receive a copy by mail.

### Typical Applications

For additional application examples, refer to the K Series User Manual.

**Locking IEC for AC Power**

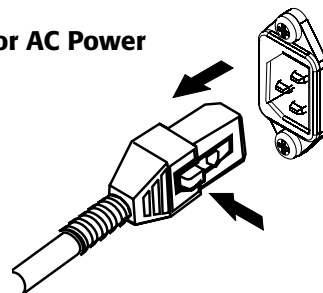

**Multiple Input Options**

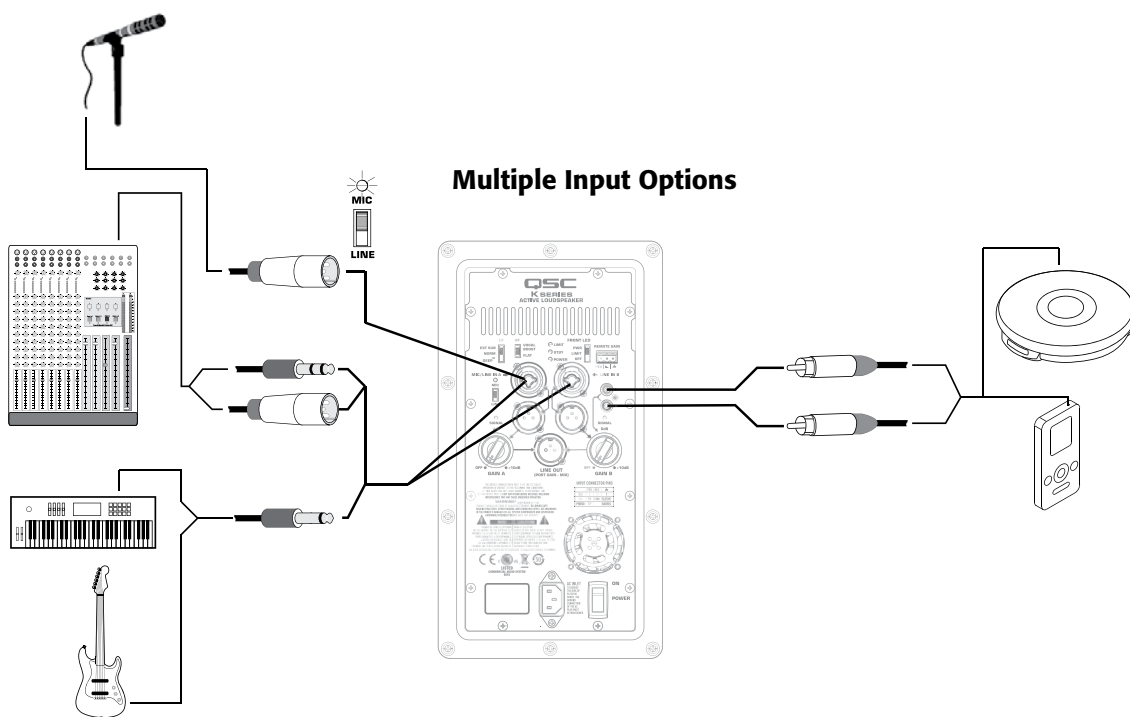

**Passing Signal from One K Series Full-range Model to Another**

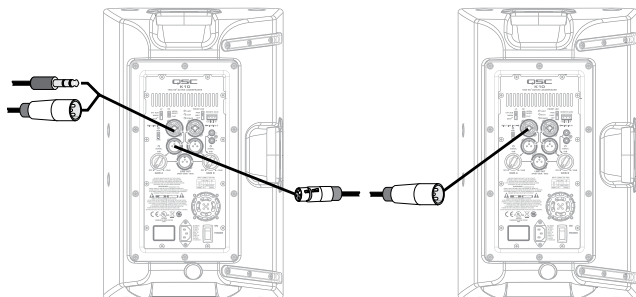

**Passing Signal to KSub**

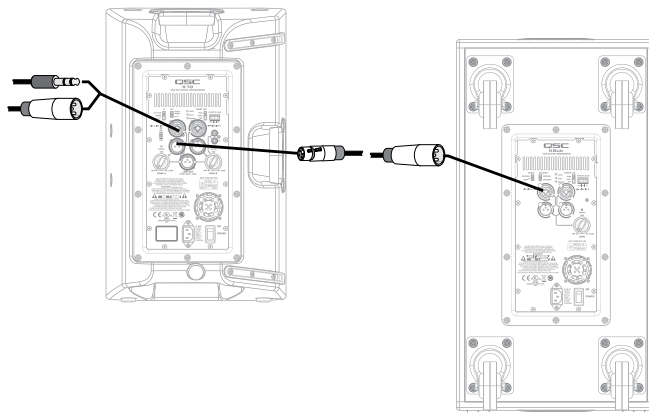

TD-000276-00-C



**Typical Applications** (continued)

**Common Stand-alone Small System  
Passing Post-Gain-Mix Signal to the KSub**

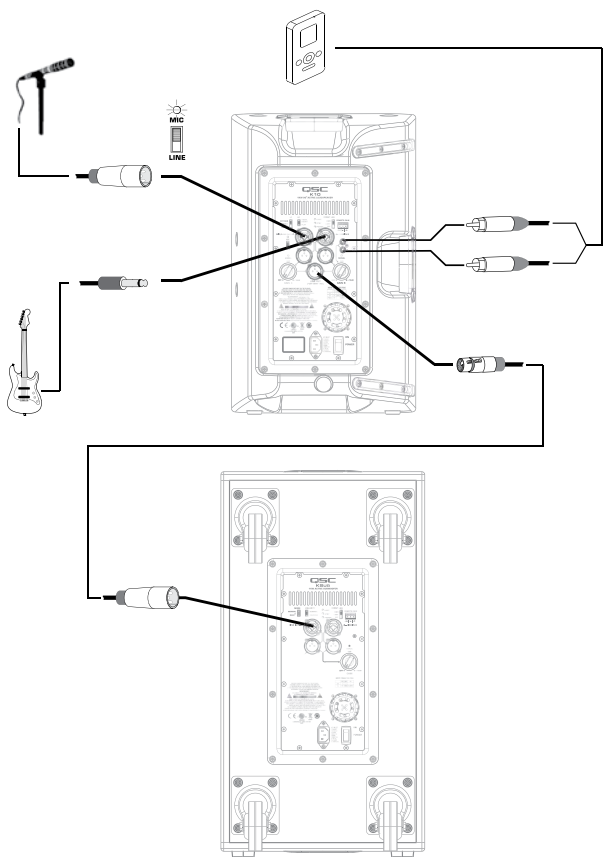

**Common Stereo System  
Passing Signal from the KSub**

